

# knowmorelondon

Spring 2006 | [www.morelondon.com](http://www.morelondon.com)

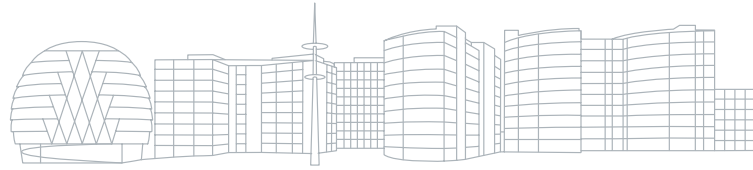

## Hilton at More London – coming to life

We meet up with the Hilton team to find out what's happening in the run up to the opening of the hotel

### Also inside this issue:

Hilton at More London – Coming to life  
37° – More London's brand new health club opens!

Development update

Potters Fields Park closed for renovation

A sizzling summer spectacle at the Scoop at More London

A partnering approach to helping out in the local community

More Community: Volunteering in Southwark

## More Developments

# Hilton at More London – Coming to life

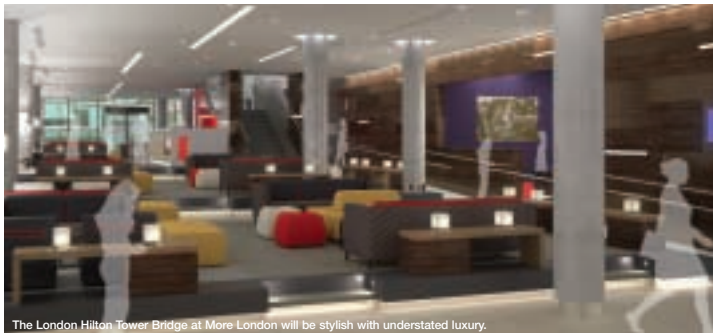

The London Hilton Tower Bridge at More London will be stylish with understated luxury.

The Hilton London Tower Bridge is due to open in September this year but with the cranes having left site and no visible activity outside, passers-by may be wondering what's happening now. *Know More London* met up with Alexa Carre – assistant to the General Manager of the new hotel – to find out how the finishing touches to the construction at 5 More London Place are coming along and what is involved in the run up to the opening of a new 4-star hotel.

*Know More London* was keen to understand what attracted Hilton to choose More London as the location for their newest hotel in London. With nearly 20 hotels in the capital but only the Hilton London Docklands south of the river, the company wanted to have another central, south-of-the-river location. More London being a prestigious development, with large businesses located in the area and the high level of tourists that visit the locality with its wealth of museums, galleries and other visitor attractions, make this an ideal location to be able to offer the benefits of this worldwide hotel brand.

### Who will be involved in running the hotel?

Alexa works alongside Guy Klaiman, who is the General Manager of the hotel. Both Alexa and Guy have worked for Hilton for a number of years and make up what will ultimately be a 15-strong team managing a total of 127 staff. Working with Guy and Alexa currently are a facilities manager, a human resources manager, a revenue manager, a sales manager and a sales executive. Recruitment for the other management positions has been finalised, appointing staff from within Hilton's

existing team, some of whom have worked with Guy before. This ensures continuity and that the Hilton standard permeates the hotel from the outset.

So far recruitment hasn't started for reception, restaurant and bar, kitchen, housekeeping and conference and banqueting staff. This will commence shortly with a view to everyone starting in August to enable an intensive training period before the hotel opens in September. Alexa and the HR manager are working closely with local job centres in Southwark as the company is keen to attract local people to work in the hotel. They feel that people who live locally will be passionate and knowledgeable about the area – a huge benefit to the guests – and this will also enable the hotel team to support the local community.

Alexa has worked for Hilton for 11 years and would highly recommend it. She says that every day is different, there is always something going on and the buzz of a hotel is unlike working anywhere else. Every hotel is unique, so you never tire of the industry, and if you get fed up with the UK, the benefit of working for an international company like Hilton, is that you can transfer abroad.

### So what's going on at the moment?

Hilton predict that up to 70% of the More London hotel's business will be corporate, with local companies taking advantage of the proximity of the hotel to their offices, clients and advisors. However, Hilton is also expecting a substantial number of leisure guests and, in order to encourage both UK and international

tourists, the team is planning initiatives that will take advantage of the unique selection of nearby attractions and amenities. This will include cookery weekends, where Executive Chef, Jonathan McCann (previously of The Dorchester, Claridges, The Westbury and Mansion House), will take guests to Borough Market to buy produce which they will then cook in the hotel kitchens.

At the moment, Alexa and the team are actively marketing the hotel and are already busy with conference enquiries. The attractive design, natural light and flexibility of the conference spaces (they can accommodate everything from small meetings for 2 up to large elaborate events for 400), as well as the location (close to the river with very easy transport connections) means the More London Place venue is already proving popular as a conference destination.

The team is also hugely busy sourcing the equipment for the day-to-day operation of the hotel. Hilton has a preferred supplier list for "absolutely everything" and this ensures the guests receive the same high standard in each Hilton hotel. However, as this hotel is quite unique and the hotel team is determined to do something a bit different, there is still a huge amount of work involved in getting quotes for everything from glasses to towels, ovens to sofas, vases to mirrors, gym equipment and food produce.

Like any hotel, the number of deliveries required is huge, including daily deliveries from bakeries, greengrocers, and butchers and of course the laundry. The design of the loading bay and delivery areas has been carefully considered to make the process of taking deliveries and distributing them to the appropriate parts of the hotel as smooth as possible. This system is also being put in place at the moment.

**And finally...** The Hilton London Tower Bridge team is also planning a grand opening party. Whilst Alexa couldn't divulge any secrets, she pointed out that General Manager Guy Klaiman wants the hotel to be seen as a "sexy hotel", so *Know More London* thinks we can look forward to something pretty spectacular in September!

If you are interested in learning more about the hotel, including hard hat tours in advance of the opening, details of conference facilities and rooms, or even a job, please contact the Hilton team on 020 3002 4300.

## Development update

At the end of 2005 the main structures of 3 and 4 More London Riverside were completed. The next step towards the buildings' completion and their handover to the occupiers, international law firms Norton Rose and Lawrence Graham, is the delivery of the main mechanical and electrical plant. The main plant equipment is installed onto the roof of the buildings and the majority of it is pre-fabricated and pre-tested which means it can simply be "bolted-up and plugged-in".

At the same time, the internal fit-out of the buildings is well progressed with high quality finishes being installed to the central toilet and core areas, atrium, stairs and entrances. All of the twenty lifts in the two buildings are nearing completion, which will mean the two temporary external hoists, which have been used to transport workers, materials and equipment up and down the buildings, can be removed.

The project is currently peaking at a labour level of over 500 operatives working towards practical completion this July in preparation for handing over to occupiers Norton Rose and Lawrence Graham to undertake their bespoke fit-out. It is expected that Lawrence Graham will move in during the Spring and Norton Rose early Summer 2007.

Two significant milestones have recently been achieved outside the buildings. The upgrading of Weaver's Lane, which has included a turning circle for disabled access to City Hall has been completed and the repaving and widening of The Queen's Walk up to Tower Bridge, the first phase of the Potters Fields Park redevelopment works, is also complete.



3 and 4 More London Riverside.

# 37° – More London's brand new health club opens!

The waiting is over! More London's new health club, 37° opened its doors on 10th May. Located on More London Riverside between HMS Belfast and the Scoop, the club's name is derived from every person's core body temperature of 37°, a basic part of good health.

The facilities provided in 37° are second to none. As well as a huge gym in an architecturally stunning space and a 20m swimming pool, there is an indoor golf lounge containing the world's most technically advanced golf simulation equipment. You can

play a round of golf in your lunch hour on your choice of over 50 of the world's top courses. If you are a beginner, why not book a course of lessons with their resident Golf Pro.

There is a stunning exercise class programme with over 100 classes taking place each week across the three studios. Classes include dance, Pilates, Yoga and Spinning. 37° is also the first health club in London to feature Method Putkisto which is influenced by Pilates and Yoga but concentrates on balance and deep stretching.

37° offers personal training through the Phoenix Coaching System™ an intelligent training system designed to maximise your exercise time. By making sure you do the right exercises with the correct form in the right number at the right pace with enough rest time and relevant stretches, you can get your body responding in half the time. That means you can spend less time at the gym and still get the results you want!

If boxing is your thing there is a 14ft boxing ring where you can spar and have one-on-one training. For the less energetic there is a

sauna, steam room, sun beds, hairdressing salon, beauty treatment room and a fantastic juice bar. A private medical centre is also located in the club, offering the very best in corporate and primary healthcare as well as sports massage and osteopathy. The Mayor, Ken Livingstone, formally opened the club on 16th May and was very impressed with what he saw. Already 70 of his staff have taken up membership.

**For details on how to become a member visit [www.thirtysevendegrees.co.uk](http://www.thirtysevendegrees.co.uk) or call 020 7940 4937.**



Entering the transformed Potters Fields Park from Tooley Street.

# Potters Fields Park closed for renovation

Potters Fields Park has now been closed to allow the development works that will transform the park to meet the needs of its many and varied users. The new design will be inclusive, sympathetic to the local area and befitting to its high-profile location. The park redesign includes an associated management and maintenance plan and a dedicated Trust organisation to oversee and ensure it is kept to a high quality for all to enjoy in years to come. The £3m project is being funded and managed by the Pool of London Partnership, Southwark Council and More London.

The new park has been designed by internationally renowned landscape architects Gross Max following extensive public consultation that informed the design. Gross Max are also the designers of public space projects such as The Bullring in Birmingham and the award-winning Lyric Square in London.

The design elements of the renovated park will include open and secluded lawns, tranquil gardens with herbaceous planting; a riverside space planted with new blossoming cherry trees and containing a new, purpose-built cafe; and new feature entrance gates. There will also be spaces for events and performances.

The works to the park have already started



and the widening of the river path has been completed, which enables people to continue using the area. While the extensive renovations are taking place the park area will remain closed to the public. It is anticipated that the principal elements of the park will be completed in December 2006, however, to allow for the optimum planting season for the gardens and a bedding-in period for the lawns, the park will reopen in Easter 2007.

See following issues for more detail on the different areas of the Park.

## In brief

Research International is currently fitting out floors three, four and part of five of 6 More London Place for occupation in July this year.

## More Events

# A sizzling summer spectacle at the Scoop at More London

More London launches its fourth summer of events in the Scoop in June, kicking off with More Movies:

Come and discover London's riverside amphitheatre and enjoy free film screenings late into the evening from 7 to 30 June. Following its success in 2005, More Movies returns to the Scoop at More London with an eclectic selection of classic, cult and contemporary films with thrillers, romance, sci-fi and film noir rarely screened elsewhere.

As the sun sets and the lights on Tower Bridge start to twinkle, you can settle back and enjoy your favourite film or check out a less well-known movie that you've never seen before.

The screenings begin between 9.30pm and 10.00pm, but the Scoop is open all evening so you can unwind after a long day and take the chance to chat with friends, treat yourselves to a picnic and enjoy the evening summer sun before the film starts.

No need to book, no tickets required, just turn up and take a seat by 9.15pm.

### Get grooving to More Music!

Get closer to some of your favourite musicians at one of the Scoop at More London's friendly free concerts during More Music. Each Tuesday to Friday in July there will be lunchtime and evening concerts for you to experience a huge variety of music. From gospel to Latin, rock to pop, big band to R&B, and jazz to funk, there will be something to tempt all tastes and the odd well-known name appearing on the line-up. Bring some friends and a picnic and enjoy some spine-tingling music in the relaxed riverside atmosphere.



Dancing to The AllStars at the Scoop at More London in 2005.

## More Movie programme

Wednesday 7 June

**Brief Encounter**  
(1945, 86 mins, UK, certificate PG)

Thursday 8 June

**Chinatown** (1974, 130 mins, USA, certificate 15)

Friday 10 June

**Moulin Rouge!**  
(2001, 127 mins, USA/AUS, certificate 12A)

Wednesday 14 June

**Some Like it Hot**  
(1959, 120 mins, USA, certificate U)

Thursday 15 June

**Blowup** (1966, 111 mins, UK/Italy, certificate 15)

Friday 16 June

**Walk the Line**  
(2005, 135 mins, USA, certificate 12A)

Tuesday 20 June

**Social Cinema** A unique cinema project by students from the Architectural Association as part of the London Architecture Biennale. Includes a screening of 'Pool of London'.

Wednesday 21 June

**The Wicker Man**  
(1973, 102 mins, UK, certificate 15)

Thursday 22 June

**Alien – The Director's Cut**  
(1979/2003, 115 mins, UK, certificate 15)

Friday 23 June

**Nine Queens (Nuevas Reinas)**  
(2000, 114 mins, Argentina, certificate 15)

Wednesday 28 June

**Dr Strangelove**  
(1964, 93 mins, UK, certificate PG)

Thursday 29 June

**Cabaret** (1973, 124 mins, USA, certificate 15)

Friday 30 June

**The Constant Gardener**  
(2005, 129 mins, Germany/ UK, certificate 15)

For an outline of the plot of each film, please visit:  
[www.morelondon.com/thescop](http://www.morelondon.com/thescop)

More Music is brought to the Scoop at More London in conjunction with The Allstars.

### The Scoop's theatrical tradition continues...

Throughout August and into September the Scoop will host its most ambitious theatre programme to date, including a revival of Bertolt Brecht's much-loved fable *The Caucasian Chalk Circle* and *Cyclops!* a riotous 2000 year old comedy-adventure by Euripides.

Brecht's play is a symbol for conflict everywhere and – produced with The Steam Industry's combination of live music, song and fine acting – it promises to capture the imagination of all ages. In the best tradition of family entertainment at the Scoop, the Steam Industry will bring Odysseus's battle with the Cyclops to life with the same mixture of comedy, puppets and live original music that made last year's *Treasure Island* such a hit.

For more information and dates and times visit [www.morelondon.com/thescop](http://www.morelondon.com/thescop), or call 020 7403 4866 to find out more.

Watch out also for a new photographic 'exhibition', the Mayor of London's Big Dance, storytelling, and the Thames Festival.



Enjoying Quadrophonia during More Movies 2005.



Theatre suitable for all ages at the Scoop.

## More Community

### More Community: Volunteering in Southwark

As part of More London's ongoing programme of involvement in the local community, in January the More London Estates management team hosted a lunchtime reception called More Community for representatives of occupiers at More London who are responsible for community relations for their company. The purpose of the reception was to give the different companies an opportunity to develop volunteering relationships within the wider Southwark community, and explore and exchange ideas for community involvement.

Speakers from volunteering and community

organisations in Southwark also attended. These included Carol Kay – Head of Southwark Education Business Alliance; Andrew Caldwell – Business Volunteers Co-ordinator from Southwark's Volunteer Centre; Kevin Dykes – Community Involvement Manager, London Borough of Southwark (LBS); and Andrew Matheson – Community Advice and Legal Aid Services for LBS.

More London occupiers attending included representatives from Ernst & Young, Hilton, Terra Firma and the Greater London Authority. All reported that they found the More

Community meeting useful and it was subsequently suggested that it happen on a regular basis. This will now feed into the Building Bridges Task Group, the new committee set up following the successful London Bridge Business Improvement District (BID) vote. Building Bridges will be responsible for developing and overseeing the strategy for the London Bridge BID Company's engagement with surrounding communities.

The More Community forum will have a regular slot in *Know More London* where occupiers' volunteering achievements will be featured.

## A partnering approach to helping out in the local community

As the first of the articles focusing on More London occupier involvement in the local community, Ernst & Young reports on its Team Challenges programme and its recent award at the Southwark Volunteer Centre Awards. Meanwhile *Know More London* looks at two pioneering projects set up by the award-winning Southwark Education Business Alliance.

### Ernst & Young

In the last year over 350 people from Ernst & Young have taken a day out of the office to take part in a Team Challenge. Challenges have included painting murals in school playgrounds, restoring community centres, improvement works at Surrey Docks Farm, and swamp clearance! It is all part of the firm's active support for communities in Southwark. Ernst & Young's work in the borough focuses on supporting the development of young people through educational and cultural programmes and through regenerating key local resources used by young people and the wider community.

Earlier this year, the firm's commitment to supporting Southwark through team challenges was recognised by leading local charity Volunteer Centre Southwark at their annual awards ceremony. Ernst & Young was awarded 'Best Newcomer' in the 'Excellence



Carol Kay receives her award from Annika Rice.

in Employer-Supported Volunteering' category. The firm already has a further 16 challenges confirmed for this summer!

Ernst & Young works with a number of local charities. It has also developed relationships with several local schools and provides literacy, numeracy and business mentoring support, development opportunities for teachers, and strategic advice for the school. Its educational programmes are facilitated through Southwark Education Business Alliance. Ernst & Young also provides funding

for a locally based charity called WebPlay to enable students in Alma Primary School to learn about life in the USA by linking up via the Web with schools in Los Angeles.

The firm's cultural programme includes providing support for local organisations such as The Unicorn Theatre as well as productions in the Scoop at More London. It has also facilitated the involvement of organisations such as the Royal Academy of Arts in local Southwark schools.

You'll be seeing more of Ernst & Young in July when it supports Sport Relief. Ernst & Young is the honorary accountant for Comic and Sport Relief so as well as counting all the donations, it is planning to run a number of fun fundraising events in and around More London.

Ernst & Young ensures that all of its community programmes provide opportunities for its employees to get involved and learn about Southwark whilst making a lasting difference. For more information about Ernst & Young's community programmes in Southwark please contact Martin Talbot 020 7951 5605 or email mitalbot1@uk.ey.com.

**Southwark Education Business Alliance:** The Southwark Education Business Alliance is an initiative set up in 1996 by Carol Kay to develop links between schools and the business community. The alliance is facilitating a huge number of business and school partnerships in Southwark with fantastic results and in recognition of this Carol Kay won a 'Special Achievement Award' for 'Excellence in Employer-Supported Volunteering' at the Volunteer Centre Awards.

Carol also has overall responsibility for the SMASH (Southwark Movers and Shakers) and BRASS (Business Responsibility and Southwark Students) citizenship projects to which More London is contributing interim funding under the S106 Agreement.

### SMASH and BRASS: what are they?

BRASS (Business Responsibility and Southwark Students) is a pioneering project designed to extend citizenship in the national curriculum to cover the role of businesses as 'citizens' of the local Southwark community. It engages a range of local businesses in a unique form of partnership with local schools and community bodies. It benefits local young people by increasing their awareness of the role that business plays in Southwark, and enhances their skills and employability. Local businesses benefit by having a greater

understanding of how they are perceived locally and their value as local citizens. For the community there is the potential to develop partnerships to enhance local prosperity and welfare.

SMASH (Southwark Movers and Shakers) is designed to provide experience of the processes and practices of active community involvement. Local businesses and other organisations provide volunteers to work as Community Motivators advising and supporting squads of students to research, document and take action on community issues that have relevance to their lives. So far this has encompassed litter, graffiti, noise, pollution, drugs, racial hate crime and abuse. The projects end with a presentation of findings and, where appropriate, recommendations to politicians and local agencies.

The project provides similar benefits to those of BRASS for students, volunteers and businesses. Both projects operate in primary and secondary schools and are embedded within the curriculum. They also link with, and complement, the regeneration of Southwark.

For more information about getting involved in the projects please contact:

David Geffin (BRASS) on 020 7525 2893, e-mail david.geffin@southwark.gov.uk

Andrew Alleyne (SMASH): 020 7525 2864, e-mail andrew.alleyne@southwark.gov.uk

### Know More London – what do you think?

Do you have any comments about this newsletter? Is there anything that isn't featured in *Know More London* that should be, or would you like to be added to the mailing list?

Please send your comments and queries to:

Charlotte Wensley  
More London Estates Management  
2a More London Riverside  
London SE1 2DB

Or call 020 7403 4866, email: feedback@morelondonestates.co.uk

### Keeping in touch

This newsletter is produced by More London Development to keep local residents and businesses informed about developments on and around the site.

For enquiries and information:

More London Helpline:

020 7255 1901

E-mail Francesca King: f.king@urbbed.com



Ernst and Young employees celebrate completing a Team Challenge.